

Clickladd™

INSTALLATION GUIDE



www.clickladd.com

TABLE OF CONTENTS

PRODUCT DESCRIPTION.....	3
MATERIAL SPECIFICATIONS.....	3
Surface finishing.....	3
Expansion and contraction.....	3
Framing and construction building.....	3
Warranty and maintenance.....	3
PROPER HANDLING OF CLICKLAD PRODUCTS.....	4
Handling and care of products.....	4
Storage.....	5
TOOLS/EQUIPMENT AND HARDWARE.....	6
Tools needed for installation.....	6
Hardware description.....	6
Finish Information.....	7
45 degree connection technique.....	7
SYSTEM INSTALLATION.....	8
Pre-planning checklist before installation.....	8
Installation.....	11
Corner Installation.....	15

PRODUCT DESCRIPTION

Clicklad™ is an aluminum profile extrusion for high-quality building facades and decorative elements.

Clicklad™ was developed to create a perfect finish that includes the quality of the material for quick installation option either vertical or horizontal.

Available in standard lengths and widths for typical cladding styles to suit any architectural style. In addition, elements like lighting can be incorporated while maintaining it's aesthetic. An architectural application suitable for any public or private building style.

MATERIAL SPECIFICATIONS

Clicklad™ products are made of Aluminum 6063 material and are coated after the T5/T6 processes for maximum reinforcement. It is available in a variety of wood grains and solid colors that vary in surface texture and design to suit your aesthetic appearance. Custom solid colors are available upon request.

Expansion & Contraction

Low Click Rail for low rise buildings and interior walls.

High Click Rail for buildings higher than 3 stories allows you to correct structure deviations and reach a perfect finish.

Framing and constriction building

Clicklad™ product can install on each building, A layer of water protection 1 is needed at least below the Clicklad™ products in order to prevent unwanted water from penetrating into the structure

Warranty and maintenance

Clicklad™ surface no need ant maintenance for any weather conditions and surface its good for over 20 year.

It is always possible to clean the product by running water only if you are interested

PROPER HANDLING OF CLICKLAD PRODUCTS

To help prevent product damage, Clicklad™ products require proper care to and from storage areas during installation. When carrying or installing any products, it is recommended that they be moved or carried by at least two people to the standard profile over 10 feet with each support point about 4 feet from the edges and one person holding the center of the profile in a profile with a standard size smaller than 10 feet. **Carrying products without proper support can cause excessive bending that can damage the look or finish of the product.** See details below

PROFILES BELOW 10 FEET / 3 METRES IN LENGTH

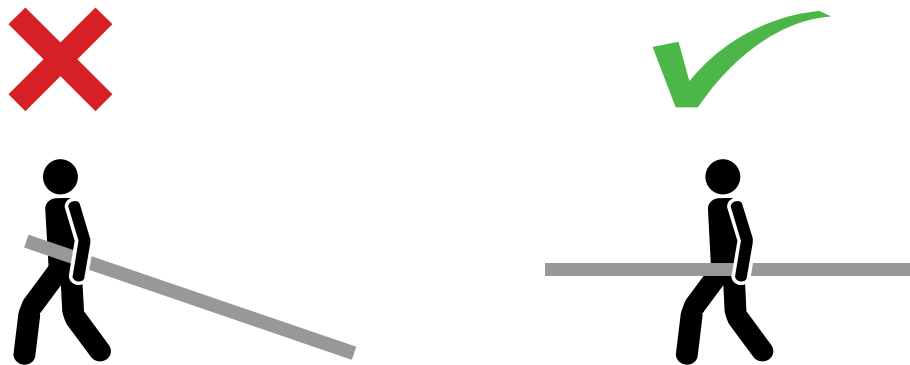

PROFILES ABOVE 10 FEET / 3 METRES IN LENGTH

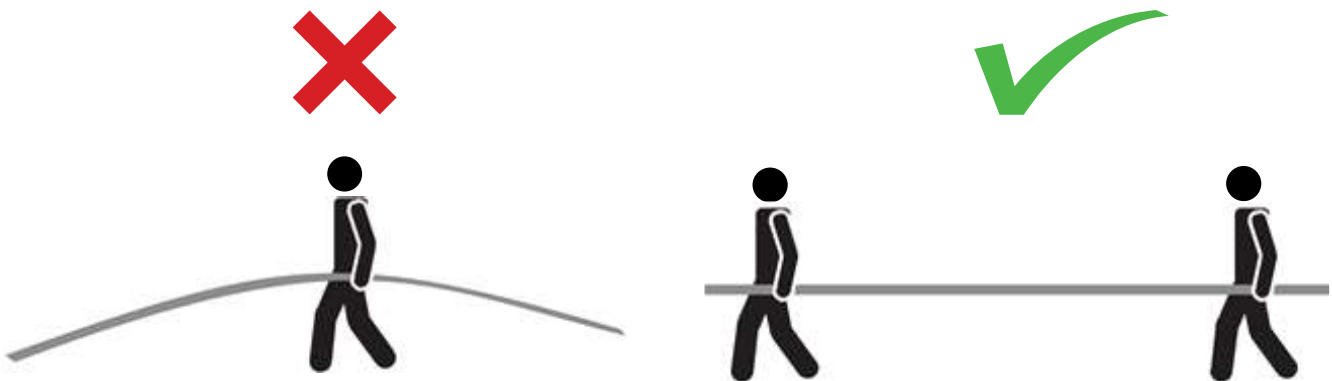

STORAGE

Clicklad product should be stored with the same method of carrying for installation or shipping. The product should be on a flat surface and without transferring weight to one of its sides in order to ensure its straightness and avoid any bend.

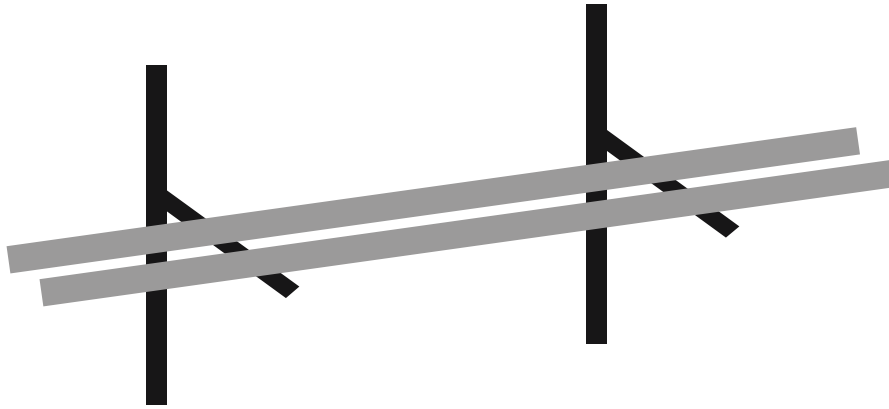

PROFILES BELOW 10FEET / 3 METRES IN LENGHT

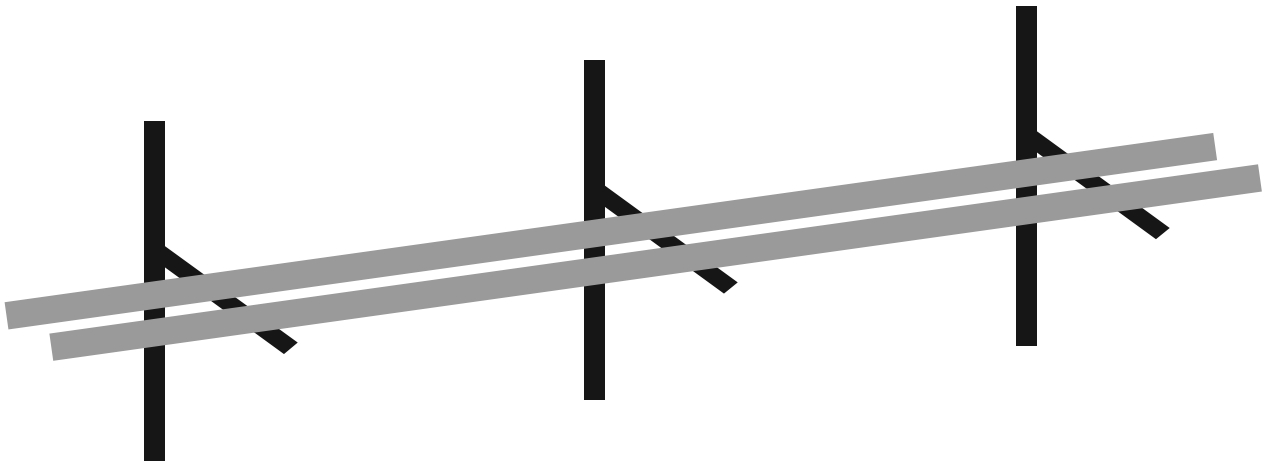

PROFILES ABOVE 10FEET / 3 METRES IN LENGHT

TOOLS/EQUIPMENT AND HARDWARE

Tools needed for installation clicklad:

- Table cutting machine
- Aluminum cutting blade
- Battery drilling driver
- Measuring tape for 25'
- Beam Level 48"-72"
- Set screw drive
- Hacksaw
- Square long
- Safety Glasses
- Stud Finders
- Drill bit for concrete, iron or wood, exaction cable, ladder in different sizes depending on the type of building you are cladding and its location.

FINISHING PROFILES FOR WALL EDGES/WINDOWS AND DOOR PROFILES:



C-054

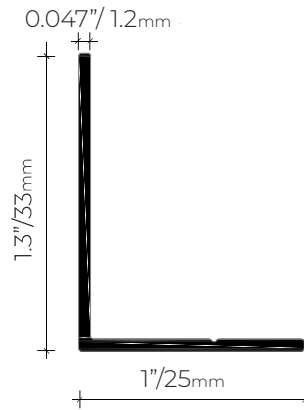

C-055

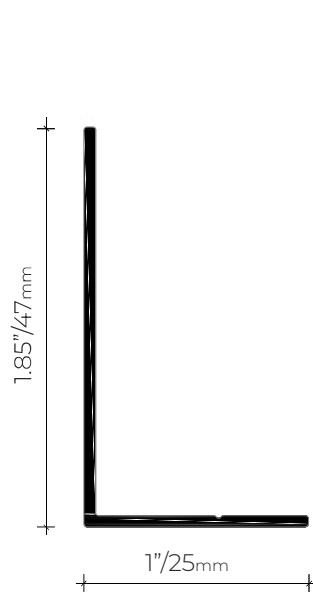

C-056

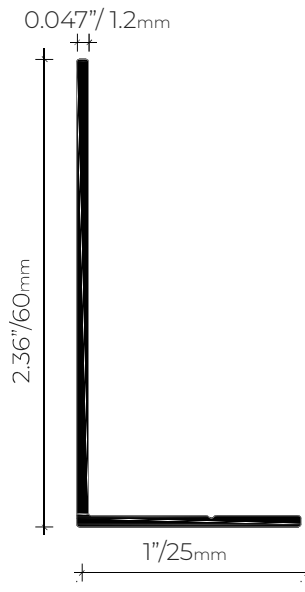

C-057

Clicklad Clip connection 45 degree profile cut according to the Clip size:

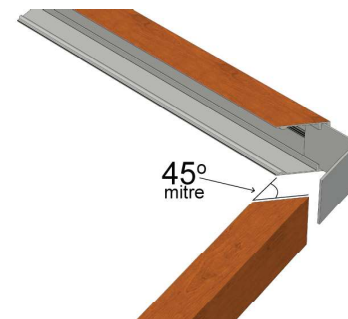
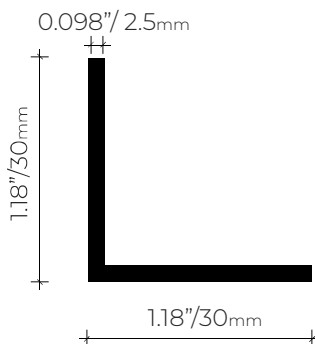

SYSTEM INSTALLATION

Pre-planning for Clicklad siding:

- Low Click Rail final distance from the wall after installation:
1"-1- 3/8"(25mm-34.4mm)
- High Click Rail final distance from the wall after installation:
1 - 7/8" - 2-1/4" (47mm-57mm)

Check list before start installation:

- Make sure that the structure is ready for installation and allow water to penetrate through the stucco or building wrap and that there are no unwanted tears or fractures.
- For their profiles with a uniform space between and use a dark back wall.
- Make sure the connections between windows / doors / roof are sealed and ready for the next step.
- Carefully plan the dimensions of the profiles in order to make connections in the center of the click rail only (see explanation below).



- Make sure well before cutting the profiles.
- Mark a straight line by laser or a long level along the wall you want to install.
(Step 1 down)
- Drill holes in the click rail for installation on the wall. Holes should be drilled in the click rail every 2ft / 600mm for the installation screw.

(the holes need to be on the teeth line to allow the rail work perfectly)

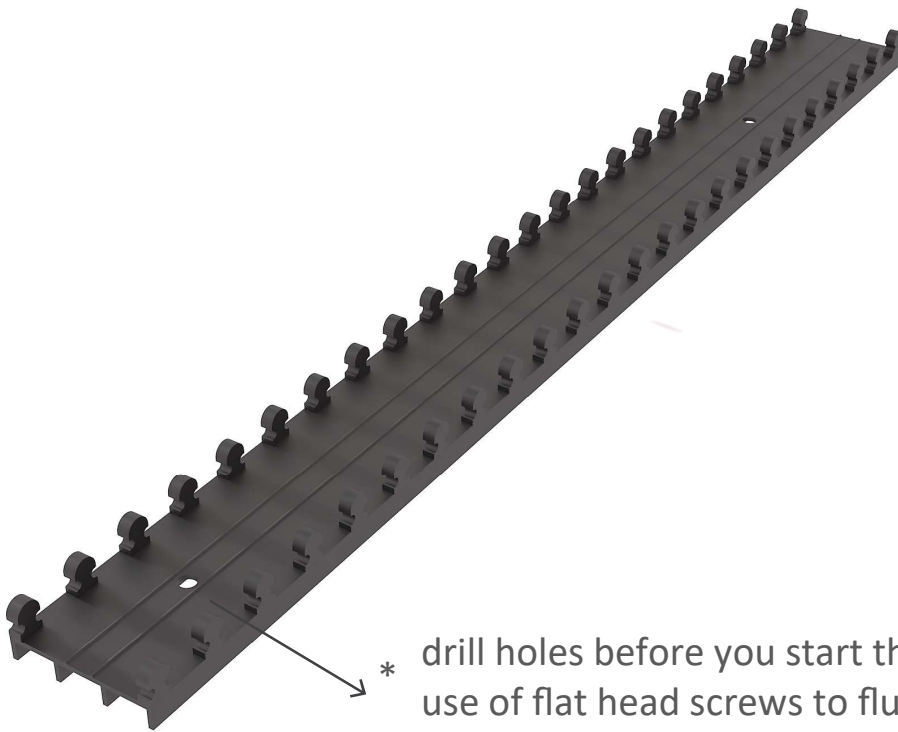

* drill holes before you start the installation, make use of flat head screws to flush with the holes after fastening

- When installing Clicked products, not all walls will be exactly enough to cover our click cladding, that's why we developed clip c-015 especially for a perfect finish to every clip. All you have to do is see that you have 3 clicks left on the rail then measurement to the end of the wall from the end off the 3 clip and cut along the profile. On the profile have designated points along to help cut the part you don't need, so you can overcome any space left after the installation. If there are less than 3 clicks left on the rail, you must use the smaller c-01 or c-013 clip that suits you best.

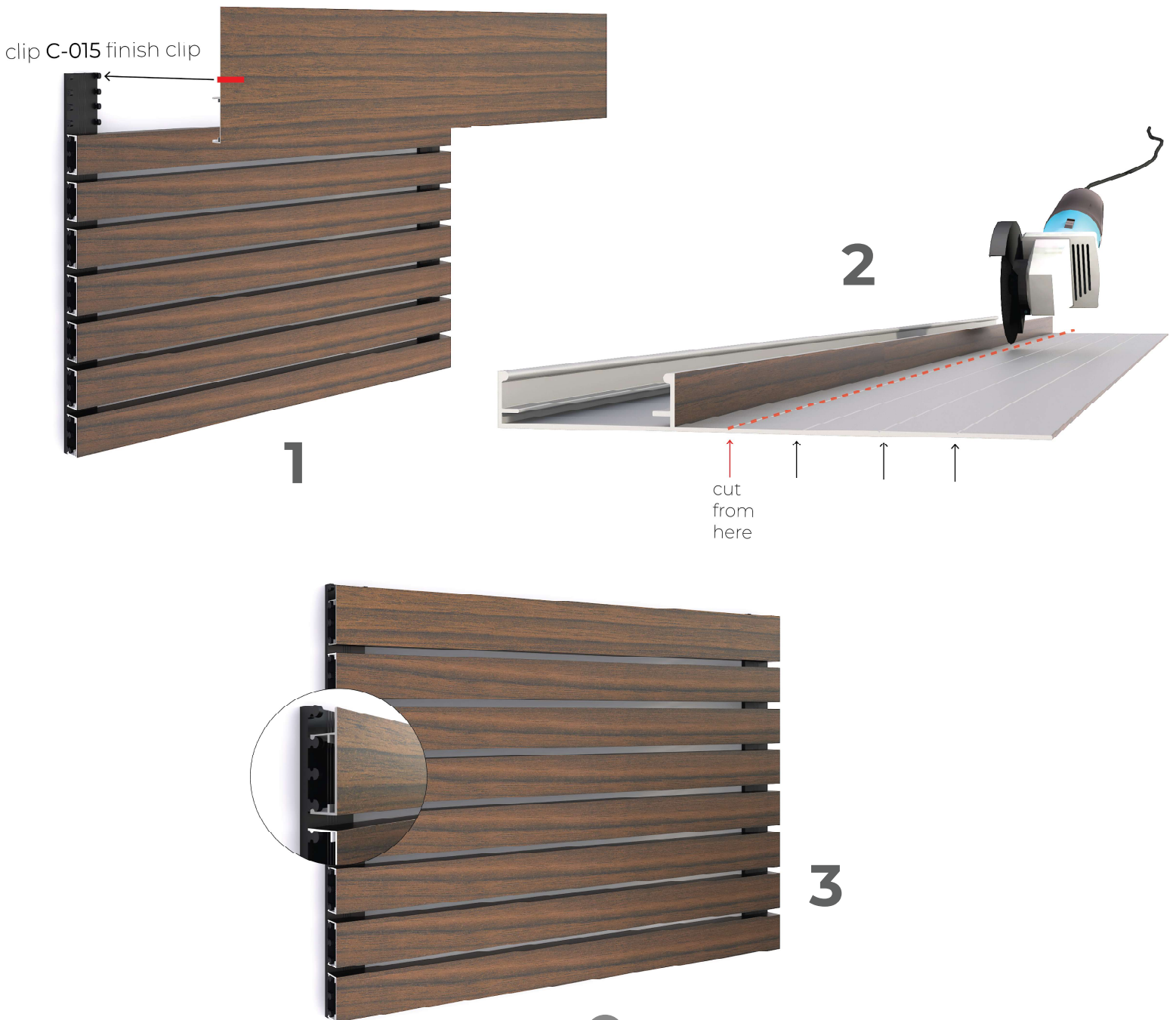

INSTALLATION

Step 1: *Make a straight line by laser or a long level along the wall you want to install.*

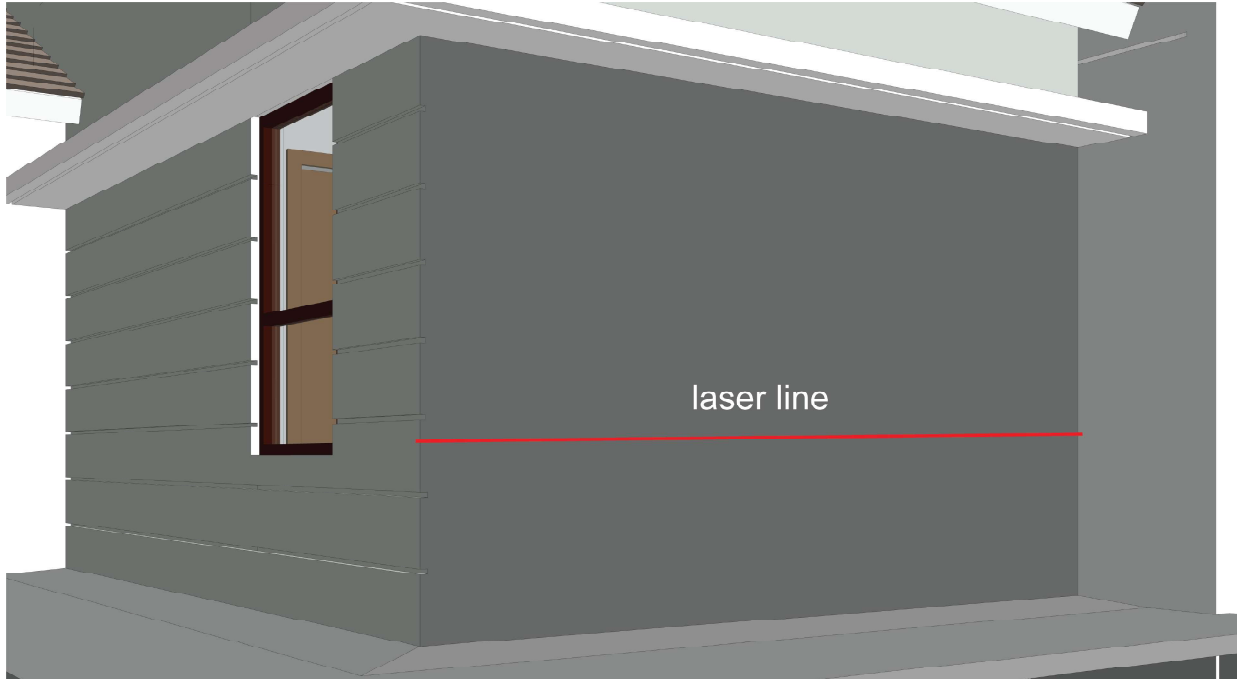

Step 2: *Install finish angle if need near the edge of the wall.*

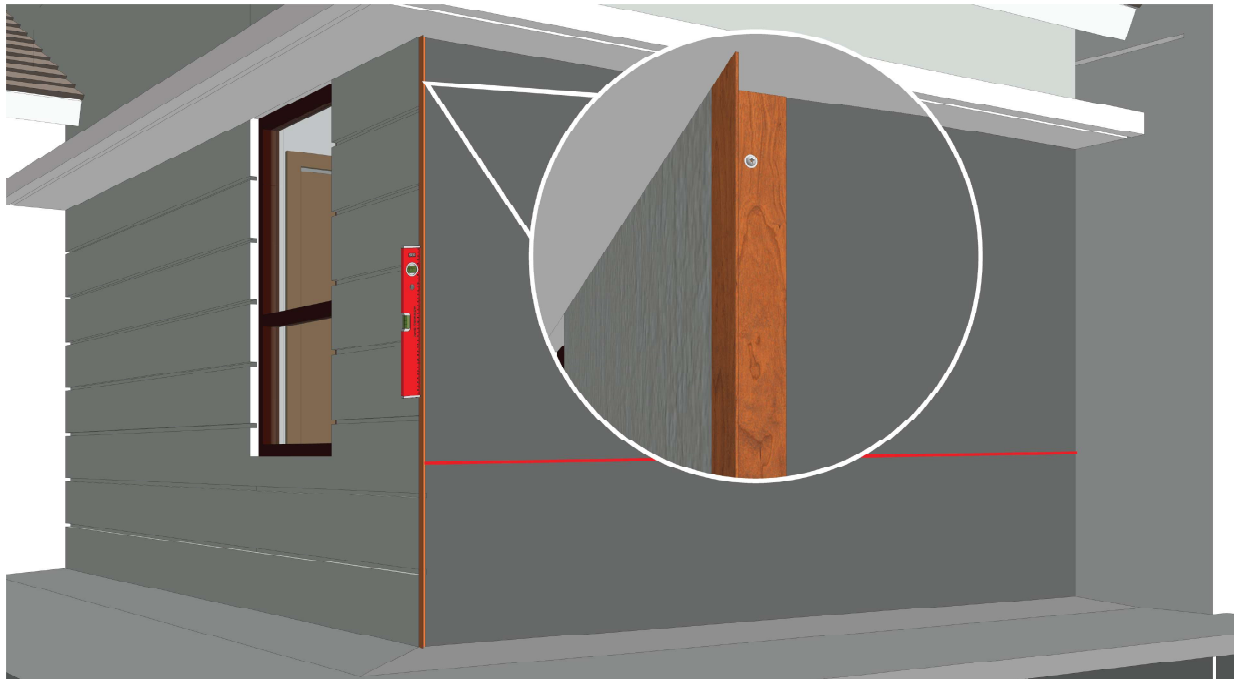

Step 3: Install the Low Click Rail by screwing to the wall.

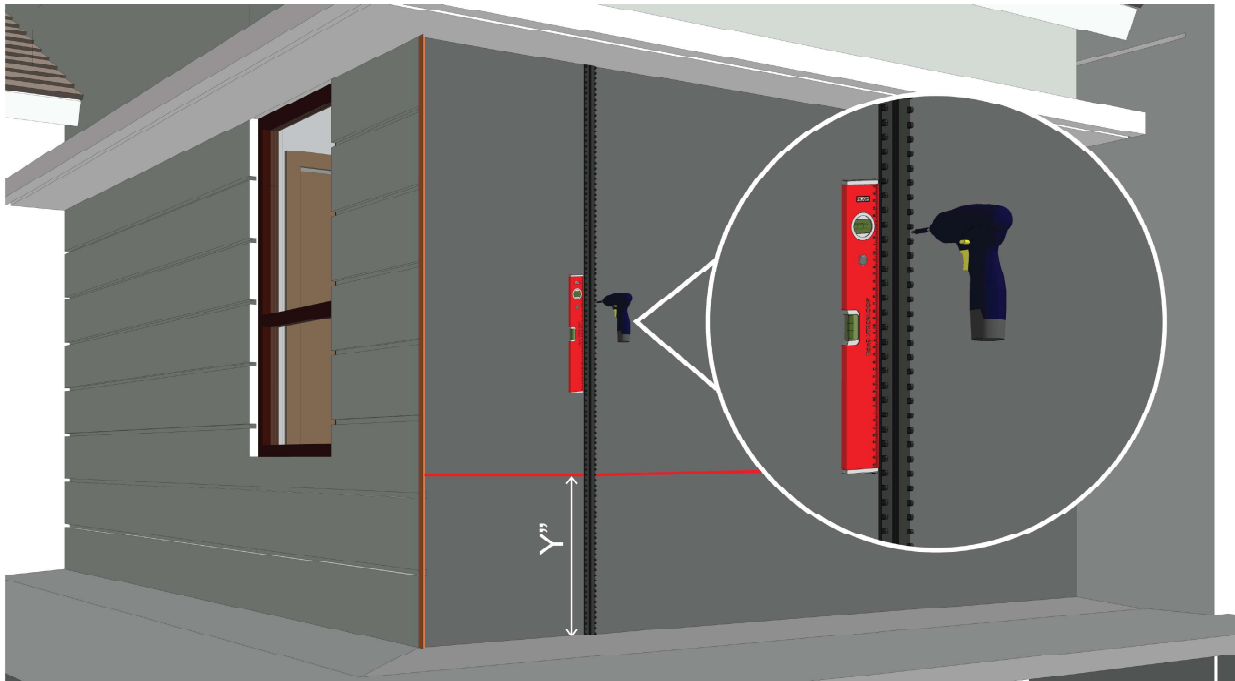

Step 4: Complete installation of the remaining Low Click Rail.

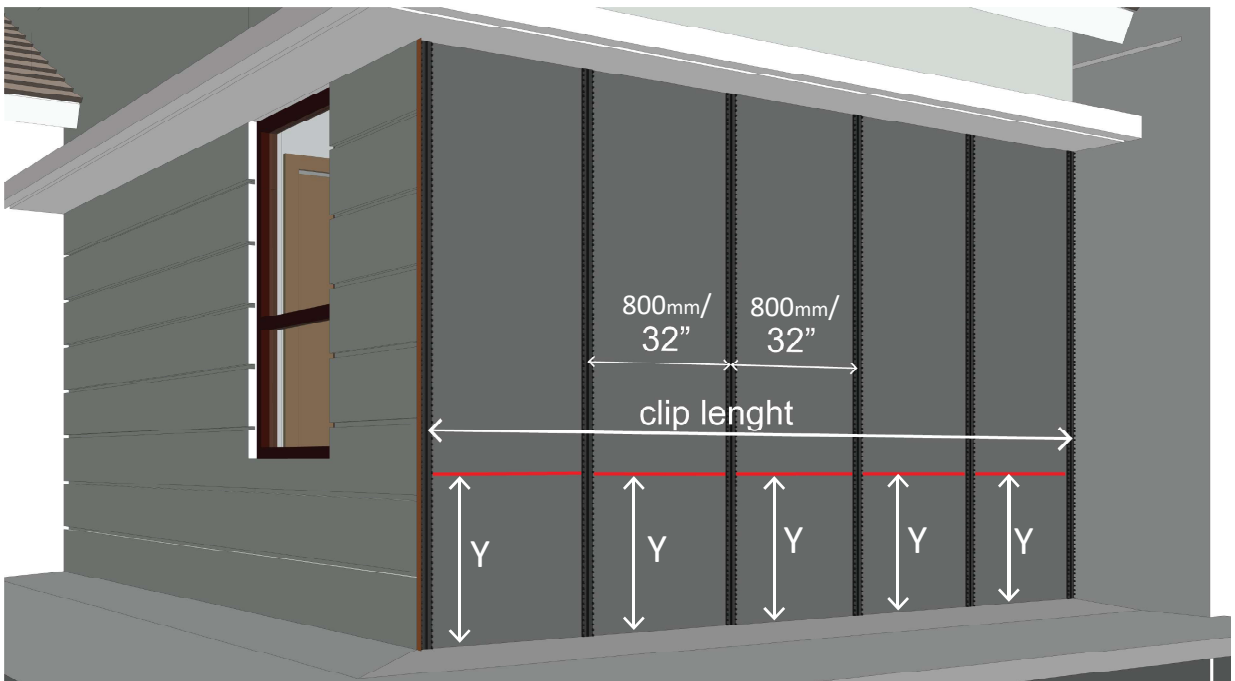

Step 5: *Install the first clip in the middle and confirm level (Clip come in from up to down).*

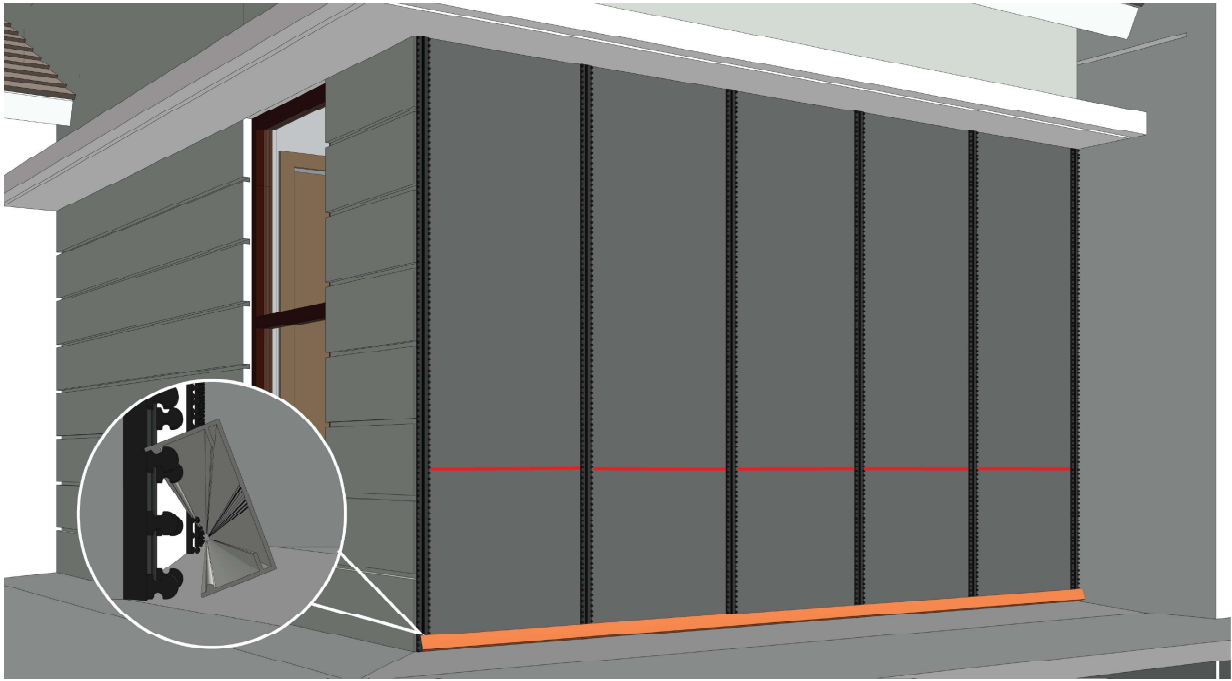

Step 6: *Before clipping the rest, confirm straightness with a spirit level.*

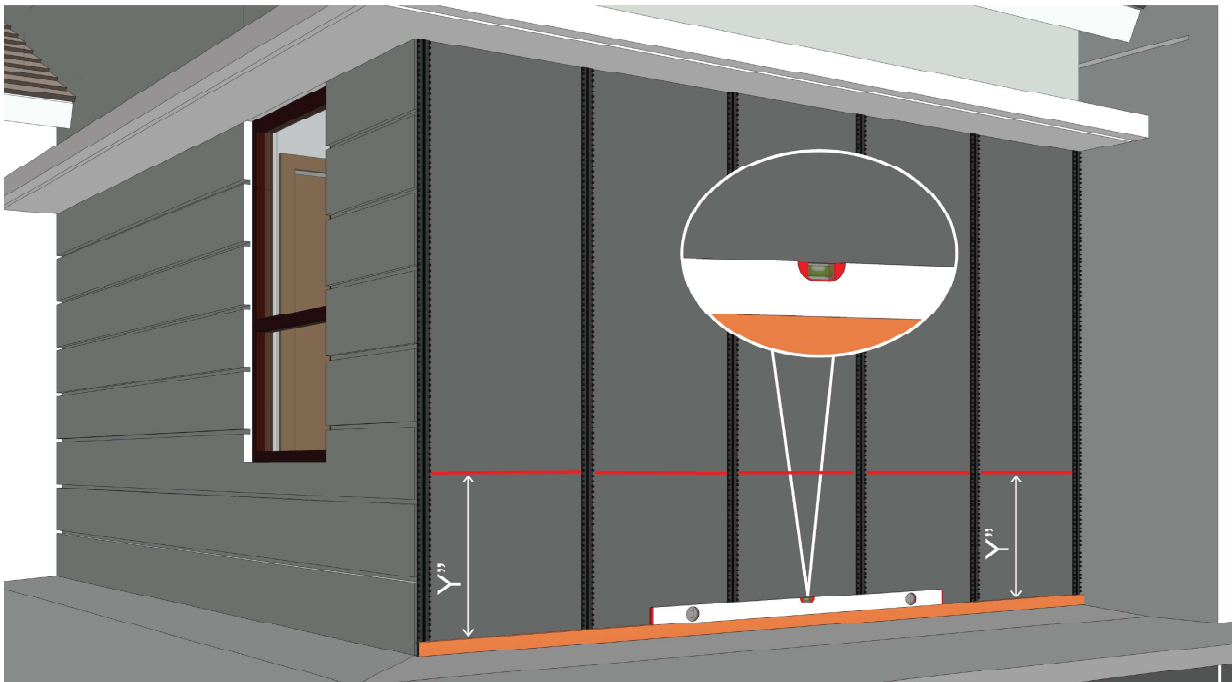

Step 7: *Clip the remaining profiles to the Low Click Rail.*

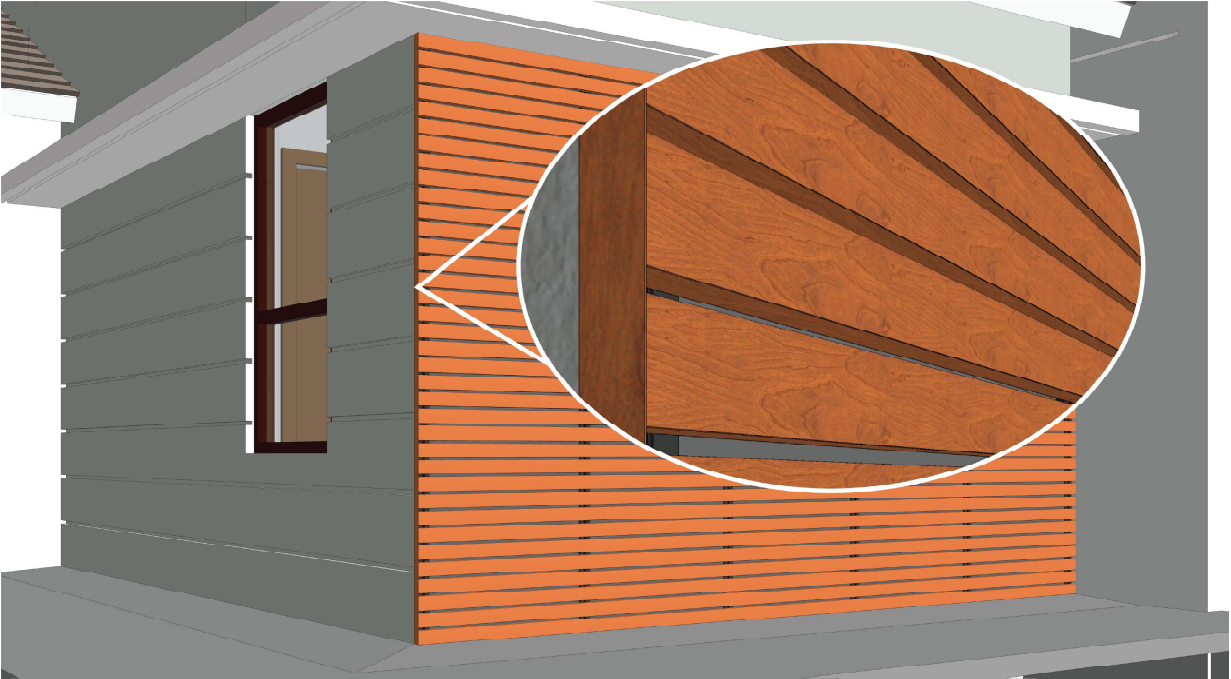

Step 8: *Finished look*

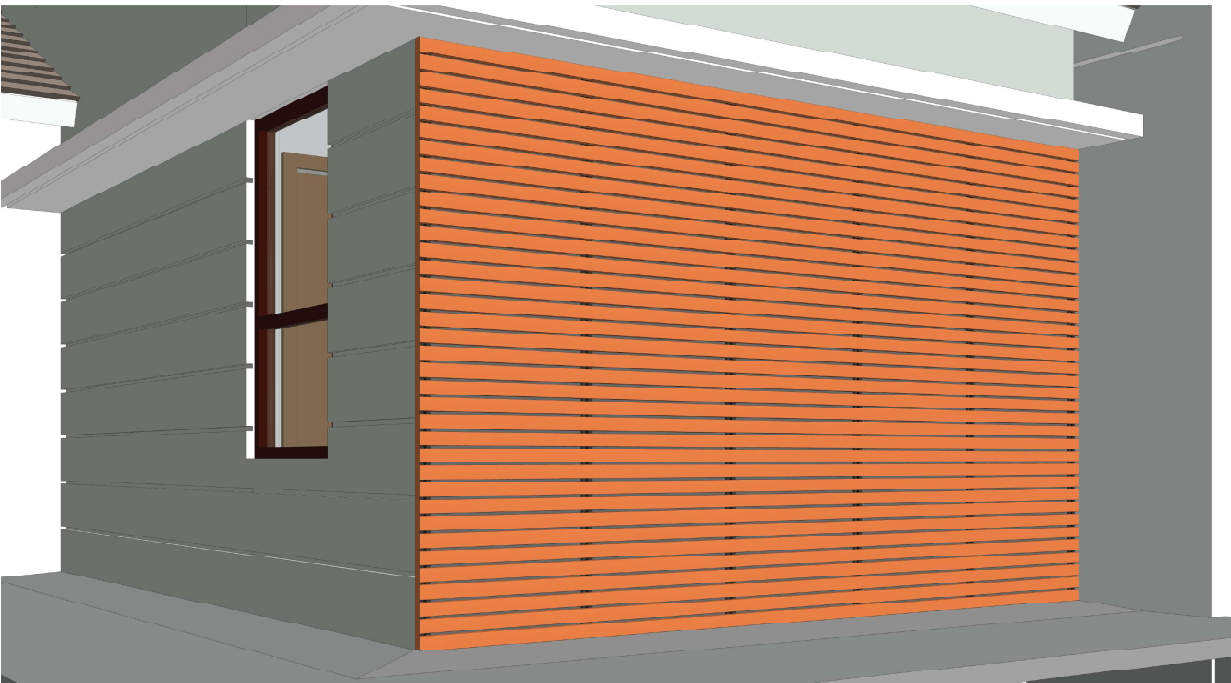

CORNER INSTALLATION

Step 1: Mark level on the wall to install the finish angle and Clip Rail.

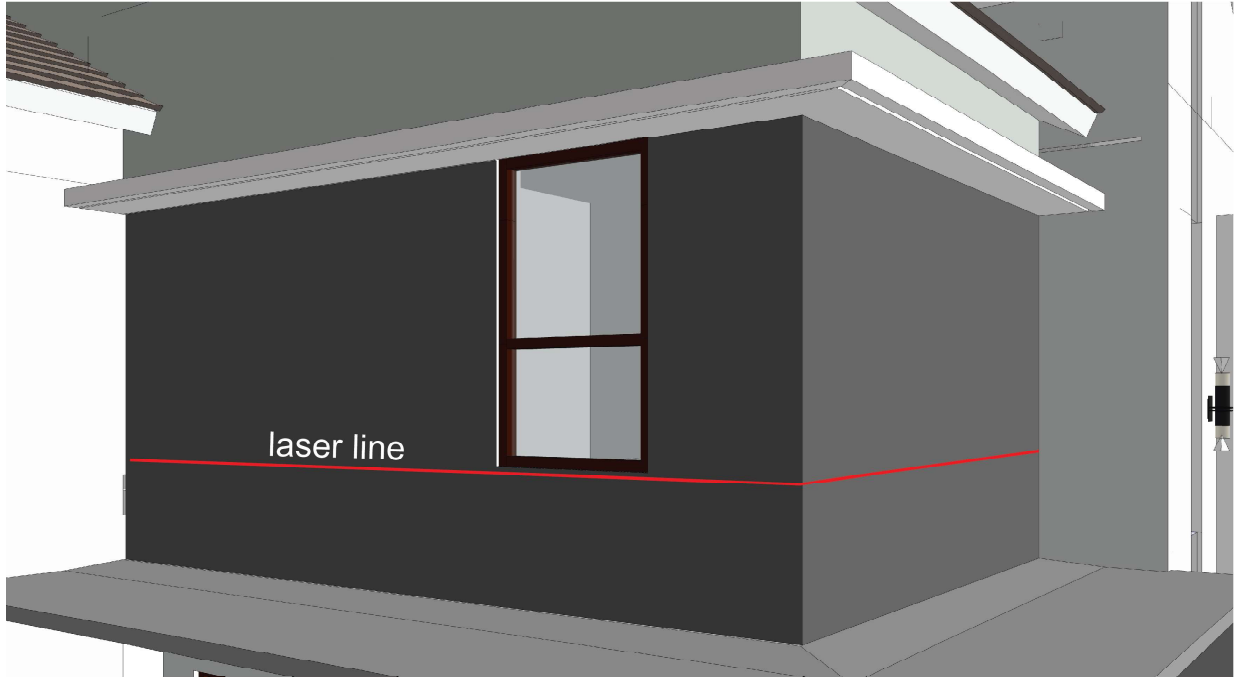

Step 2: Install the finish angle around the edge of the opening.

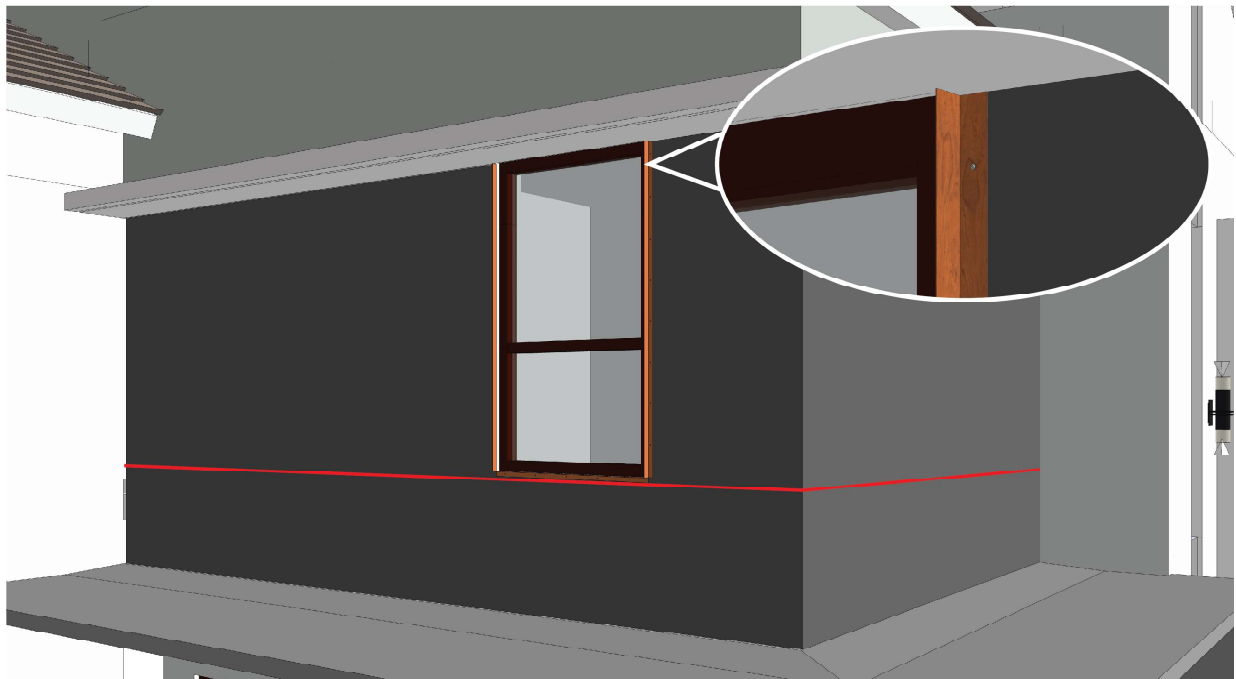

Step 3: Install the low Click Rail on both sides by screwing to the wall.

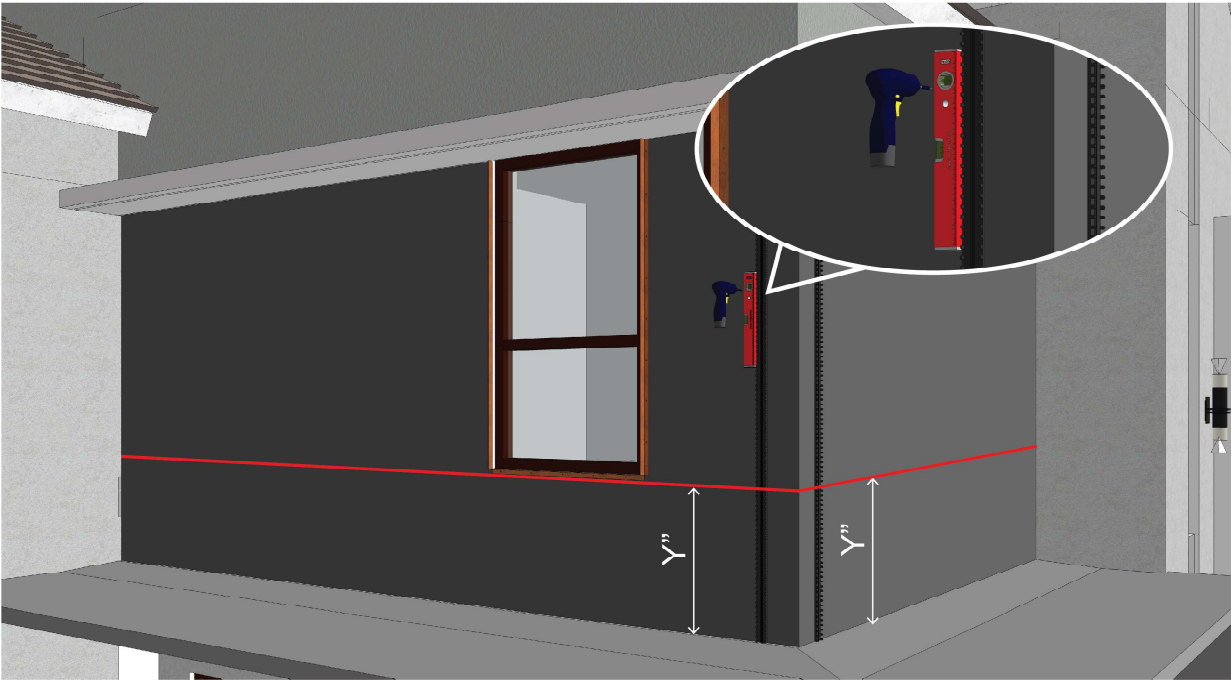

Step 4: Complete the installation of the remaining Low Click Rail.



Step 5: Install the first (A) at the right to the Click Rail, then install the dip (B) on the left with the angle. Then confirm the straightness with a spirit level.

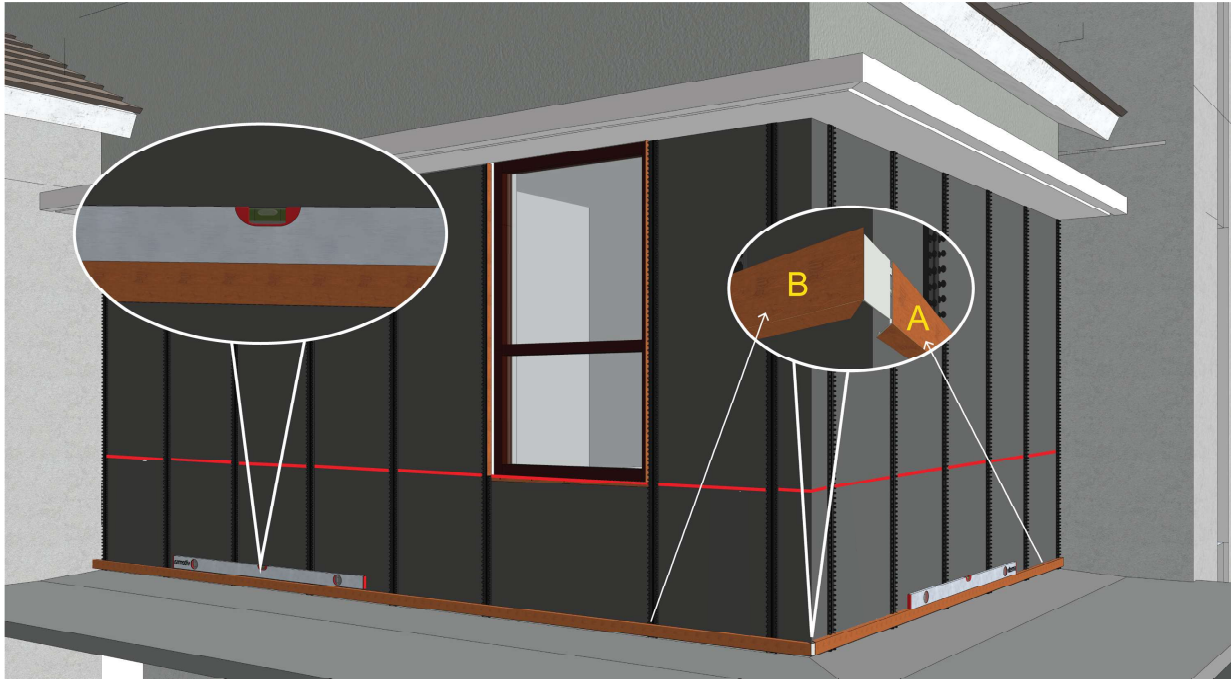

Step 6: Clip the remaining profiles in the same manner.

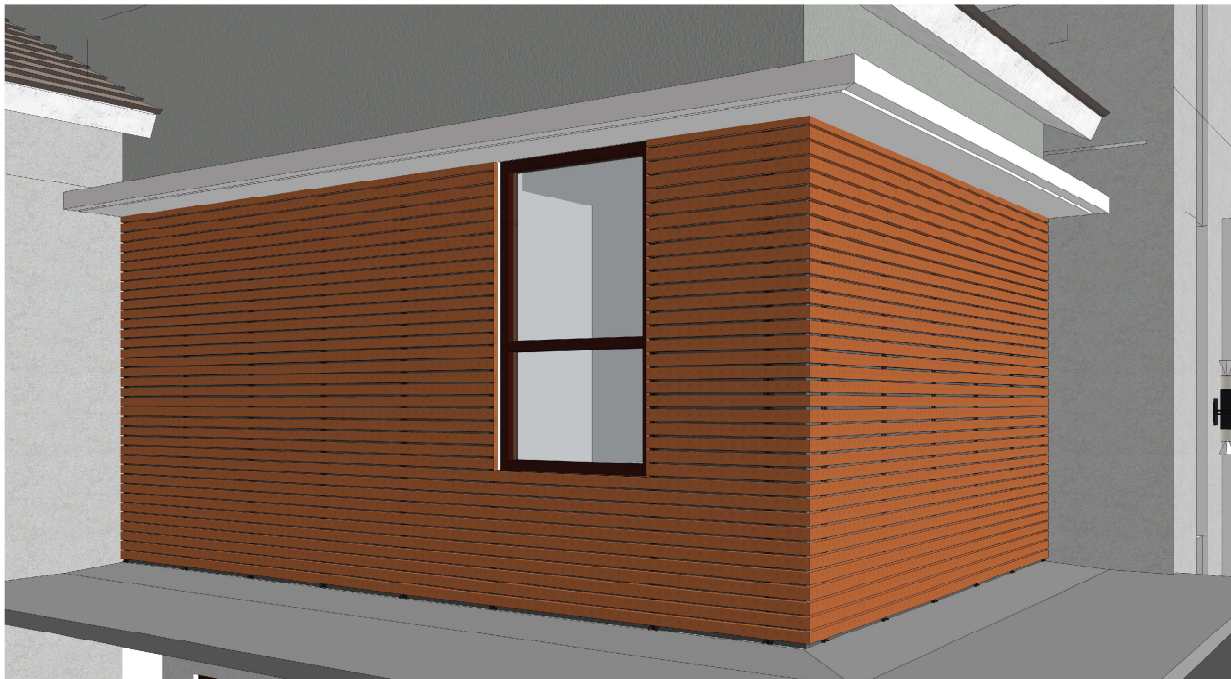



ClickladTM

INSTALLATION GUIDE

www.clickladus.com